

## EHB-EUG Series

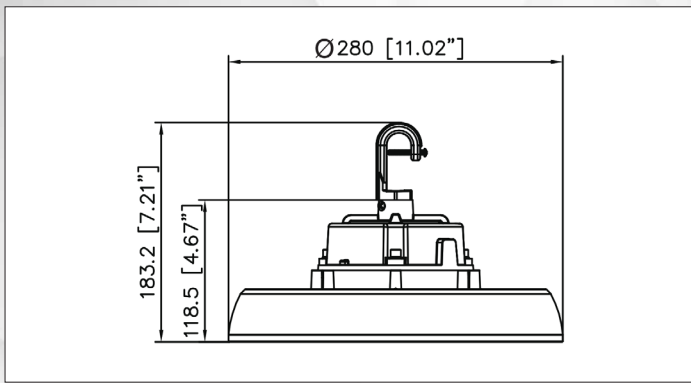

DIMENSION DIAGRAM - EHB-EUG1015W50K, 100W/150W



## FEATURES

- UFO Highbay is Designed To Replace 250-1000W Metal Halide Light or HID Fixtures.
- Over 140lm/w Efficiency.
- Power Selectable.
- Minimum 50,000 hours of Life Time.
- Motion Sensor & Dimmable Function available.
- Best Fit for Warehouses, and Retail Stores.
- Excellent heating dissipation.



DIMENSION DIAGRAM - EHB-EUG2024W50K, 200W/240W

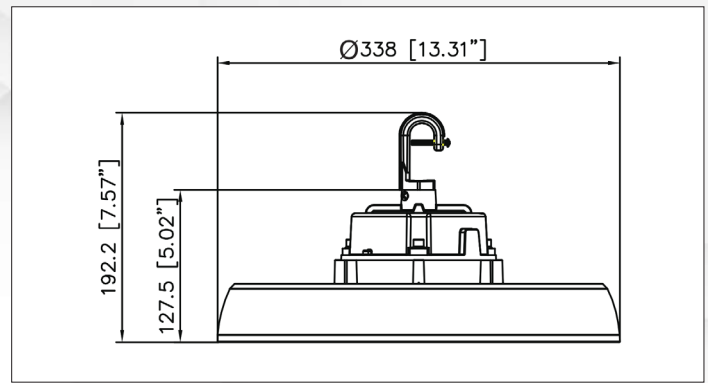

## ELECTRICAL AND LIGHTING SPECIFICATIONS

Models	EHB-EUG1015W50K	EHB-EUG2024W50K
Input Voltage	100-277VAC	
Power Consumption	100W/150W	200W/240W
Lumen Output	14,000LM/21,000LM	28,000LM/33,600LM
Efficiency	150W	
CRI	>80 RA	
Color Temperature	5000K	
Beam Angle	80°	
Working Temperature	-40°F ~113°F	
Power Factor	90%	90%
Equivalent	250W~400W Metal Halide	400W~800W Metal Halide
Lifespan	>50,000 hrs	
Dimming	Yes. 0-10V dimming	
Input Cable Length	5ft	
IP Rating	IP60	
Motion Sensor Ready	Yes (not included)	

## PACKAGE INFORMATION

Models	EHB-EUG1015W50K	EHB-EUG2024W50K
Product Weight	12.30Lbs	17.33Lbs
Package Length	12-13/16"	15-1/8"
Package Width	12-13/16"	15-1/8"
Package Height	11-7/16"	12-1/4"
Package Weight	13.70Lbs	19.10Lbs



## INSTALLATION REMARKS

- Turn off power before installation.
- Make sure the AC Power (120-277V) is connected to the right cables (L-black and N-white).
- Pink and purple cable should only be used when dimming to a 0-10V. Refer to the Dimmer Installation below
- Clean the glass of high bay light regularly to keep great lighting transmission.
- Wrong Connection will damage the product.
- Only professionals must proceed to install this unit.

## INSTALLATION INSTRUCTIONS

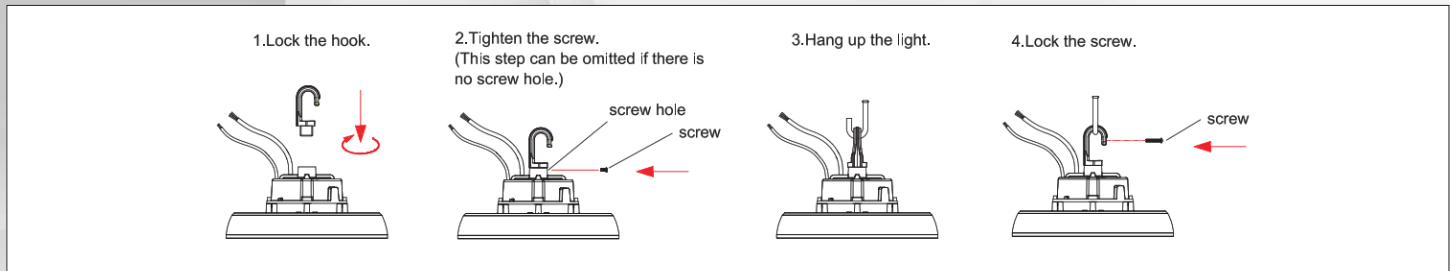

## POWER SELECTION

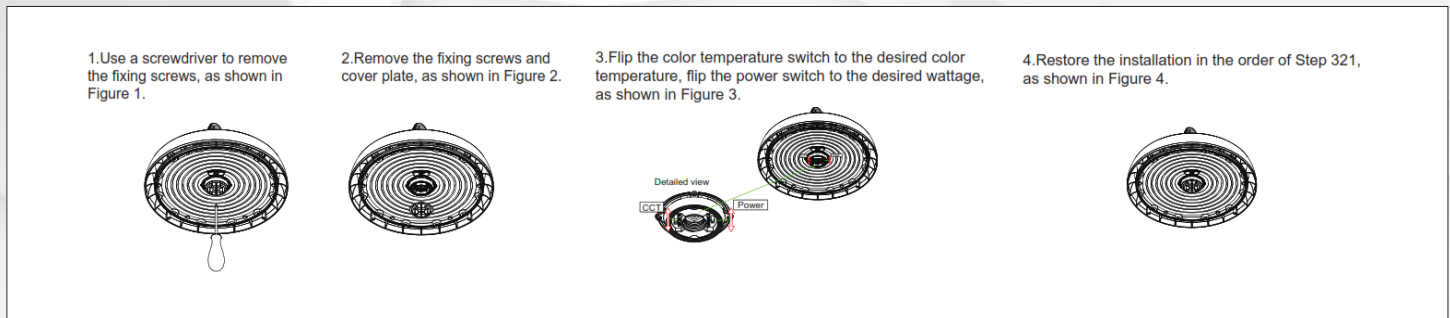

## SENSOR INSTALLATION

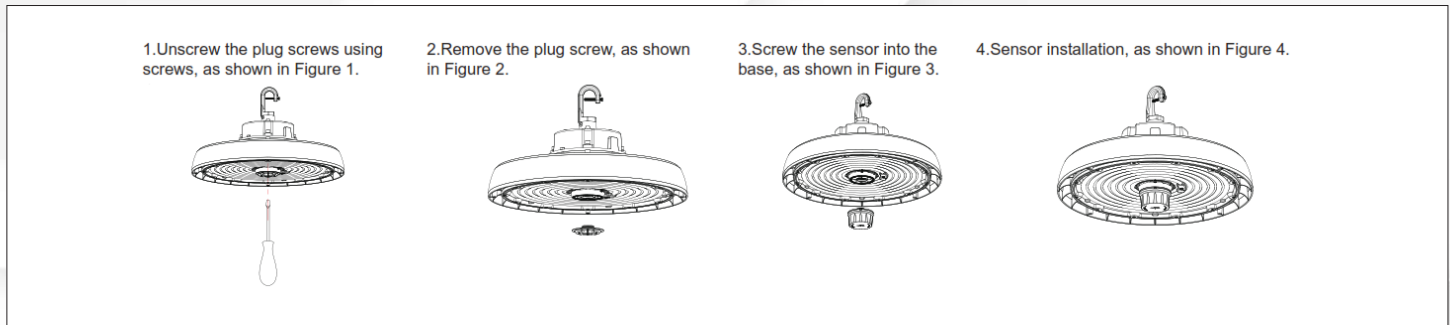

## DIMMER INSTALLATION

